

AZULLE®

Quick Guide



ACCESS3
Fanless Mini Desktop PC

What's in the box?

2



Access3

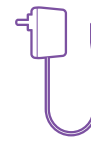

Power adapter
5V/3A



HD Adapter



Quick Guide

How can I set it up?

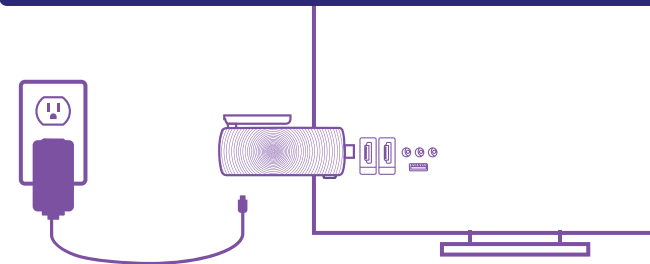

- 1 Connect the 5V power adapter to the Access3.
- 2 Insert your Access3 to the TV or monitor's HD input.
- 3 Turn on the Access3 by pressing the power button.
- 4 Choose the correct high definition input and enjoy your Access3!

Specifications 3

Processor	Intel®Apollo Lake N3350 / N3450
Operating System	Windows 10 Pro
BIOS	Wake Up On LAN / PXE / Auto Power ON
RAM	2 GB / 3 GB / 4 GB / 6 GB
Storage	32 GB / 64 GB
GPU	Intel HD Graphic (Gen9 LP) 12EU / 18EU(N4200)
WIFI	Dual band 2.4Ghz/5Ghz
Ethernet	1 Gigabit
Bluetooth	Bluetooth 4.0
HD Output	x1 Port, 4K @30fps
USB	x2 3.0 Ports
Micro SD Slot	Up to 256 GB
Audio Output	3.5 mm Jack
Power Supply	5V/3A
Dimensions	5.2 in x 2 in x 0.75 in

The perfect match!



Wouldn't it be awesome to enjoy your Access3 from the comfort of your couch? Allow us to introduce you The Lynk. It is the ultimate multi-functional remote control recognized for its smooth Gyroscope technology and audio chat capabilities complete with a backlit QWERTY keyboard and 3D motion sense handgrip for easy web browsing media streaming, and creating physically-engaged gaming experience. With the latest infrared AI technology, the Lynk is able to learn the functions of most remotes. Plug it into your Access3 and take your experience to a whole new level!

Port Layout 4

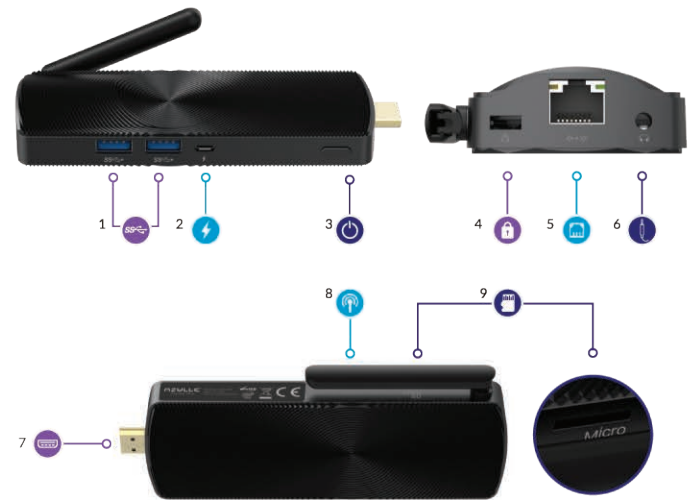

- 1 USB 3.0
- 2 Power Input
- 3 Power Button
- 4 Kensington Lock
- 5 Ethernet Port
- 6 Audio Output Jack
- 7 HD Output
- 8 Antenna
- 9 Micro SD Card Slot

Confused?

5



No worries! We're here for you.



Chat live with a real person!
www.azulletech.com



Customer Service:
786.233.6769 ext.1
Technical Support:
786.233.6769 ext.2



Email us! We'll get back to
you as soon as possible!
support@azulletech.com



If you have questions about our products or need guidance, please visit our YouTube channel, where you'll find instructional videos. If you don't find what you're looking for, please let us know. We actively seek to improve your customer experience.



Visit our YouTube channel
<https://goo.gl/b2C0vr>



Check out How-to videos
<https://goo.gl/X44CXf>



Watch product reviews
<https://goo.gl/TDe5la>

Stay in touch!

6



We would love to hear from you! We encourage you to leave a product review. Your feedback will not only allow us to improve our customer satisfaction, but it helps others make a well informed purchasing decision.



@azulletech

*Intel Inside and the Intel Inside logo are trademarks of Intel Corporation in the U.S and/or other countries.

*Windows is either a registered trademark or a trademark of Microsoft Corporation in the U.S and/or other countries.

This equipment has been tested and found to comply with the limits for a Class B digital device, pursuant to Part 15 of the FCC Rules. These limits are designed to provide reasonable protection against harmful interference in a residential installation. This equipment generates uses and can radiate radio frequency energy and, if not installed and used in accordance with the instructions, may cause harmful interference to radio communications. However, there is no guarantee that interference will not occur in a particular installation. If this equipment does cause harmful interference to radio or television reception, which can be determined by turning the equipment off and on, the user is encouraged to try to correct the interference by one or more of the following measures:

- Reorient or relocate the receiving antenna.
- Increase the separation between the equipment and receiver.
- Connect the equipment into an outlet on a circuit different from that to which the receiver is connected.
- Consult the dealer or an experienced radio/TV technician for help.

This device complies with part 15 of the FCC Rules. Operation is subject to the following two conditions:

- (1) This device may not cause harmful interference, and
- (2) this device must accept any interference received, including interference that may cause undesired operation.

Changes or modifications not expressly approved by the party responsible for compliance could void the user's authority to operate the equipment.

FCC Radiation Exposure Statement

This equipment complies with FCC radiation exposure limits set forth for an uncontrolled environment. This equipment should be installed and operated with minimum distance 20cm between the radiator & your body

AZULLE®

Guía Rápida



ACCESS3
Fanless Mini Desktop PC

¿Qué hay en la caja?

2



Access3

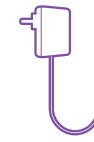

Adaptador de corriente
5V/3A



Adaptador HD



Guía rápida

¿Cómo lo instalo?

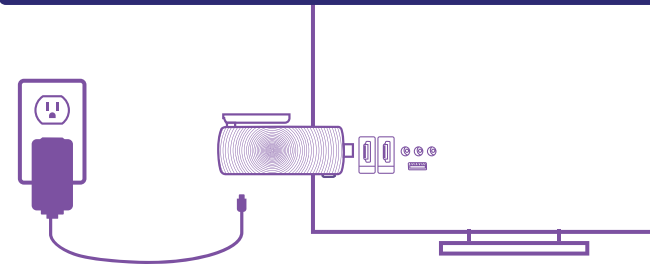

- 1 Conecta el adaptador de corriente de 5V al Access3.
- 2 Inserta tu Access3 a la entrada HD del TV o monitor.
- 3 Enciende el Access3 presionando el botón de encendido.
- 4 Selecciona en tu TV la entrada de HD correspondiente y ¡Disfruta tu Access3!

Especificaciones

3







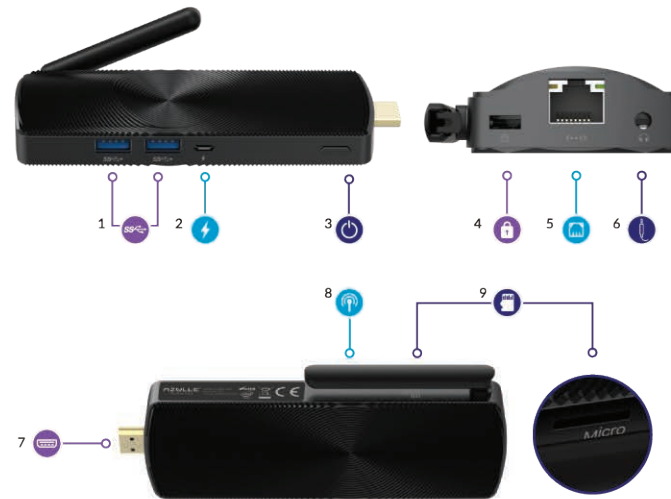

 Procesador	Intel® Apollo Lake N3350 / N3450
 Sistema Operativo	Windows 10 Pro
 BIOS	Wake Up On LAN / PXE / Auto Power ON
 RAM	2 GB / 3 GB / 4 GB / 6 GB
 Almacenamiento	32 GB / 64 GB
 GPU	Intel HD Graphic (Gen9 LP) 12EU / 18EU(N4200)
 WIFI	Banda Dual 2.4Ghz/5Ghz
 Ethernet	1 Gigabit
 Bluetooth	Bluetooth 4.0
 Salida HD	x1 Puerto, 4K @30fps
 USB	x2 3.0 Puertos
 Ranura tarjeta SD	Hasta 256 GB
 Salida de Audio	3.5 mm Jack
 Entrada de corriente	5V/3A
 Dimensiones	5.2 in x 2 in x 0.75 in

*Intel Inside y el logo de Intel Inside son marcas registradas de Intel Corporation en los E.E.U.A y otros países.
 *Windows es una marca registrada de Microsoft Corporation en E.E.U.A y otros países.

Puertos Disponibles

4



- 1  Puerto USB 3.0
- 2  Entrada de Corriente
- 3  Boton de Encendido
- 4  Bloqueo Kensington
- 5  Puerto Ethernet
- 6  Salida de Audio
- 7  Salida HD
- 8  Antena
- 9  Ranura para tarjeta SD

Confused?

5



No worries! We're here for you.



Chat live with a real person!
www.azulletech.com



Customer Service:
786.233.6769 ext.1
Technical Support:
786.233.6769 ext.2



Email us! We'll get back to you as soon as possible!
support@azulletech.com



If you have questions about our products or need guidance, please visit our YouTube channel, where you'll find instructional videos. If you don't find what you're looking for, please let us know. We actively seek to improve your customer experience.



Visit our YouTube channel
<https://goo.gl/b2C0vr>



Check out How-to videos
<https://goo.gl/X44CXf>



Watch product reviews
<https://goo.gl/TDe51a>

Stay in touch!

6



We would love to hear from you! We encourage you to leave a product review. Your feedback will not only allow us to improve our customer satisfaction, but it helps others make a well informed purchasing decision.



@azulletech

*Intel Inside and the Intel Inside logo are trademarks of Intel Corporation in the U.S and/or other countries.
*Windows is either a registered trademark or a trademark of Microsoft Corporation in the U.S and/or other countries.
This equipment has been tested and found to comply with the limits for a Class B digital device, pursuant to Part 15 of the FCC Rules. These limits are designed to provide reasonable protection against harmful interference in a residential installation. This equipment generates uses and can radiate radio frequency energy and, if not installed and used in accordance with the instructions, may cause harmful interference to radio communications. However, there is no guarantee that interference will not occur in a particular installation. If this equipment does cause harmful interference to radio or television reception, which can be determined by turning the equipment off and on, the user is encouraged to try to correct the interference by one or more of the following measures:

- Reorient or relocate the receiving antenna.
- Increase the separation between the equipment and receiver.
- Connect the equipment into an outlet on a circuit different from that to which the receiver is connected.
- Consult the dealer or an experienced radio/TV technician for help.

This device complies with part 15 of the FCC Rules. Operation is subject to the following two conditions:
(1) This device may not cause harmful interference, and (2) this device must accept any interference received, including interference that may cause undesired operation.

Changes or modifications not expressly approved by the party responsible for compliance could void the user's authority to operate the equipment.

FCC Radiation Exposure Statement
This equipment complies with FCC radiation exposure limits set forth for an uncontrolled environment. This equipment should be installed and operated with minimum distance 20cm between the radiator & your body